

CALCULATION OF BENEFITS

Production per Cropping

Ulang	P37,500	
Red Tilapia	30,060	
Catfish	<u>30,000</u>	
		P97,560 per cropping

less: Production Cost per Cropping

Feeds	P15,960	
Electricity	6,200	
Seeds	2,250	
Labor	6,200	
Depreciation	<u>3,733</u>	
		<u>P34,343</u>

P63,217

 x 3 croppings
P189,651 per year

Net Profit per Cropping

Return of Investment (ROI)	183.3%
Payback Period (Years)	0.54



FISH IN TANKS



NATIONAL INTEGRATED FISHERIES TECHNOLOGY DEVELOPMENT CENTER

Bureau of Fisheries and Aquatic Resources
 Department of Agriculture
 Tel. No. (075) 653-5412; Telefax No.: (075) 653-0385
 E-mail : bfarniftdc@yahoo.com



Published by the ASIAN FISHERIES ACADEMY

E-mail : asianfishacademy@yahoo.com
 Tel. No. (075) 653-8851

COST OF FACILITIES

Concrete tanks	-	P250,000
Submersible pump(1 hp)	-	6,000

* Calculation of Depreciation

Concrete tanks	25 yrs	-	P	3,333/cropping
Submersible pump	5 yrs	-	P	400/cropping

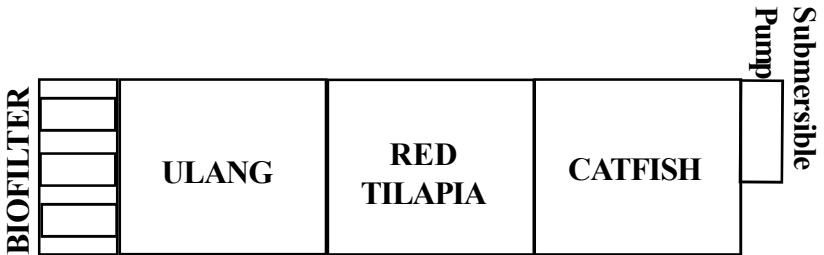

PRODUCTION PER CROPPING (4 MOS.)

Ulang

1,500 grown to 10 pcs/kg = 150 kgs
 x P250/kg = P37,500

Red Tilapia

500 grown to 3 pcs/kg = 167 kgs
 x P180/kg = P30,060

Catfish

1,500 grown to 4 pcs/kg = 375 kgs
 x P80/kg = P30,000

P97,560 per cropping
x 3 croppings
P292,680 per year

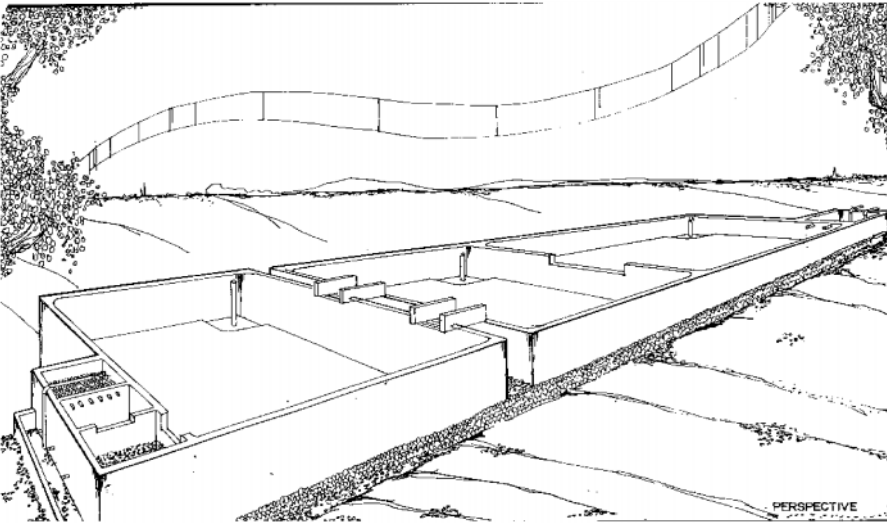
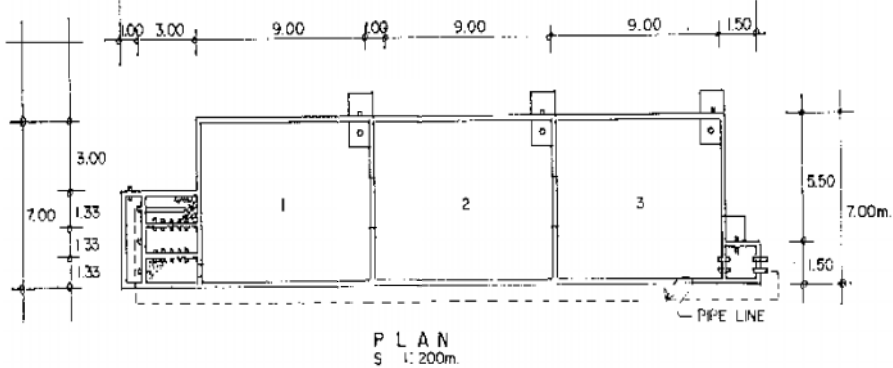

COST OF PRODUCTION PER CROPPING (4 MOS)

Feeds	42 bags @ P380/bag-	P15,960
Electricity	P50/day	- 6,200
Depreciation (tank, pump)		- <u>3,733</u>
		P25,893

Seeds		2,250
Ulang	1,000 - P1,000	
Catfish	1,000 - 1,000	
Red Tilapia	500 - 250	
Labor	31 mandays x P200	<u>6,200</u>

P34,343 per cropping
x 3 croppings
P103,029 per year